



**KALINGA INSTITUTE
OF INDUSTRIAL TECHNOLOGY**

Deemed to be University U/S 3 of the UGC Act, 1956

SCHOOL OF ARCHITECTURE & PLANNING

Address:

**Campus-I7, Kalinga Institute of Industrial Technology(KIIT)
Deemed to be University, Bhubaneswar - 751024**

✉ soumyendu.ray@kiit.ac.in ☎ (+91) 99379 75919 (Abhinandan)

🌐 ksap.kiit.ac.in 📘 <https://www.facebook.com/kiitsap/> #kiitsap

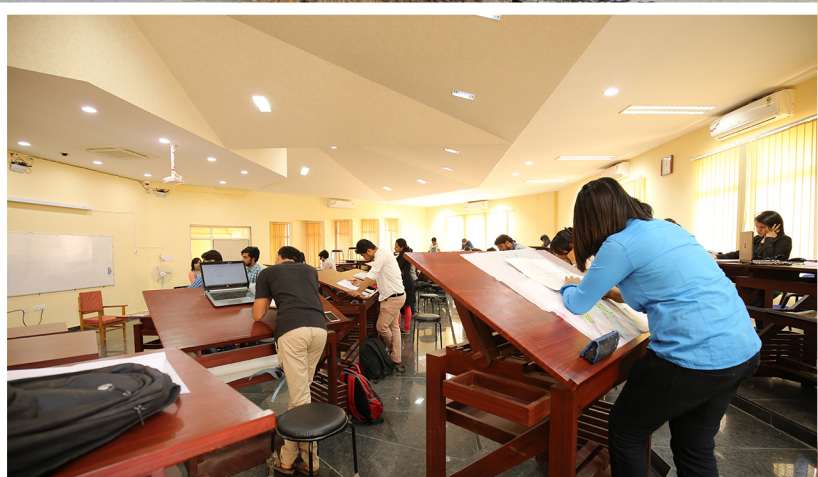

Rich in diversity, creativity and scholarship, KIIT School of architecture and Planning offers full time course in architecture at under graduate level with a mission to educate future designers to shape collaborations, synthesize complexity, and catalyze transformation for public good and foster research in all scales of the built environment - local, regional, national, and international.

Students are exposed to issues and trends of Architecture, Design and Planning by a competent faculty drawn from diverse expertise. Critics and theorists from around the world supplement the faculty, and together, they introduce students to various approaches and innovative architectural practices with a fascinating balance of theory and studio sessions. The School brings together the expertise of architecture, industrial design, interior design, landscape architecture, urban design, visual communication, and environmental science, with relevant subjects from arts, humanities, engineering and technology and harmonizes a platform for creative learning. Students develop comprehensive, multi-dimensional skills of sustainable building design and construction practices; specific skills include imagining, designing, drawing, architectural presentation, research and writing, computer applications, technical and managerial aptitudes in problem definition and solution seeking.

With a strong foundation of multi-disciplinary skills, the students emerge as built environment consultants par excellence.

Approved by
Council of Architecture



Affiliated to
Indian Institute of Architects,
New Delhi



ACADEMIC PROGRAMME

Bachelor of Architecture (B.Arch) – 5 years programme - 40 seats

ELIGIBILITY CRITERIA

60% marks in aggregate and with Mathematics, Physics and Chemistry as subjects of examination at the end of 10+2 scheme of Senior School or Certificate Examination.

SELECTION PROCEDURE

Through KIITEE (KIIT Entrance Examination)

AND

Valid NATA (National Aptitude Test in Architecture) score

OR

Valid JEE Score (Paper 2- Aptitude Test in Architecture)

as prescribed by the Council of Architecture(www.coa.gov.in)



PEDAGOGICAL INNOVATION

- Focus on 'Learning by Making'
- Continuous Assessment, exposure to life site design challenges, emphasis on both theory and studio sessions
- Industry assisted courses
- Hands on experience, compulsive interface with practicing architecture professionals
- Prominent faculty across the breadth of the field both from core and allied subjects
- Experimental Methodology: Zynga Studio, off site joint studio exercise with centres of diverse expertise, Innovative use of materials
- Vernacular building experiences; Clay modelling, Bamboo Studio , recycled waste reuse

RESEARCH THRUST AREAS

- South East Asian Vernacular Architecture
- Energy conservation and Sustainability
- Disaster Resistant Structures
- Specialty Building Design
- Historic preservation and heritage conservation
- Affordable housing
- Behavioural studies
- Parametric & Computational Design

LABORATORIES

- Material testing, advanced concrete and digital mapping Laboratory
- Model Making, Virtual Environment Simulation workshop
- Climatology Laboratory
- Carpentry, pottery, ceramic, metal casting studio
- 3D animation and Virtual Imaging studio
- Art & Sculpture Gallery, Archive of World Architecture, Material museum
- Illumination, Acoustics ,
- HVAC, MEP Laboratories
- Digital sketching, Aerial Photography, Videography, Film making Studio
- Construction Yard

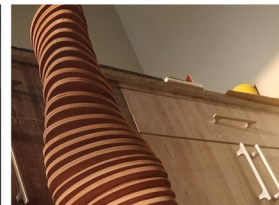
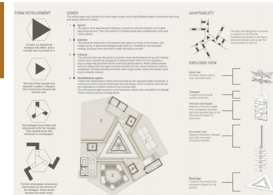
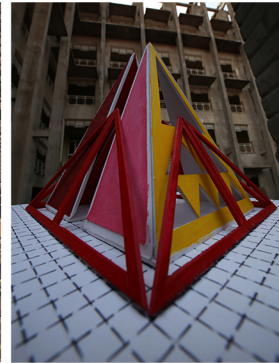

COLLABORATIONS

- Academic exchange and Research collaboration with Texas Tech University, USA and University of Pecs, Hungary
- Industry-sponsored electives on façade engineering by Glass Academy Foundation and SAINT-GOBAIN
- Industry supported advanced laboratories by Dalmia Cement
- Smart city initiatives partnership with IBI Group and Bhubaneswar Urban Knowledge Centre (BUKC)



TEXAS TECH
UNIVERSITY.



PÉCSI TUDOMÁNYEGYETEM
UNIVERSITY OF PÉCS



Urban Sketchers

FACULTY

Academically accomplished faculty with distinct industry recognition from across the breadth of the field draw a seamless balance between theory and practice.

Soumyendu Shankar Ray
Director



Ganesh Prasad Meher
Professor



Sudha Panda
Associate Professor



Himanshu Sekhar Panda
Associate Professor



Chandana Parida
Assistant Professor



Priyanka Mishra
Assistant Professor

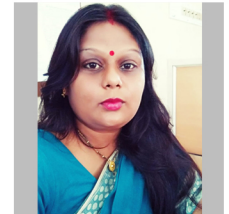

Sukanya Dasgupta
Assistant Professor



Sabyasachi Mohanty
Assistant Professor



Parthiba Chakraborty
Assistant Professor



Abhilasha Singh
Assistant Professor



Swati Gautam
Assistant Professor

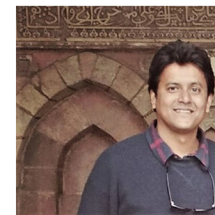

Auro Ashish Ghosh
Assistant Professor



Apurwa Agrawal
Assistant Professor